

**INTER-UNIVERSITY ACCELERATOR CENTRE**  
**(An Autonomous Centre of University Grants Commission)**  
**Aruna Asaf Ali Marg, New Delhi-110 067**  
**Phone: 011-24126018/22/24/25/26 Fax: 011-24126041**

**NOTICE INVITING TENDER**  
**(TENDER NO: IUAC/NIT/12/HAR/ 2020-21)**

Online tenders are invited in two bid system on behalf of the Director, Inter-University Accelerator Centre (IUAC), New Delhi through e-Procurement Portal from contractors who have experience in CPWD/State PWD and those on approved list of MES, Railways, Autonomous Bodies, State/Central Govt./ undertakings or Public limited Company / Organizations for the following work:

Name of work: MS platform cum connecting corridor with door openings from R. No. 111 Main Lab Building (Proposed FEL Control Room) to BH III G.Floor (towards FEL Lab).

| Sl. No | Estimated Cost (in Rs.) | Time for Completion | Last date & Time of receipt of Tender | Date & time of opening of tenders | Price Bid Opening date |
|--------|-------------------------|---------------------|---------------------------------------|-----------------------------------|------------------------|
| 1.     | Rs.12,44,000/-          | 90 days             | 22/12/2020 at 3.00pm                  | 23/12/2020 at 3.30pm              | To be intimated later  |

Aspiring Bidders who have not enrolled/registered in e-Procurement Portal should enroll/ register before participating through the website <http://eprocure.gov.in/eprocure/app>.

The bids shall be submitted online only at CPPP website: <http://eprocure.gov.in/eprocure/app>. Tenderers /Contractors are advised to follow the instructions provided in the e-procurement portal. Bid documents may be scanned with 100 dpi with black and white option which helps in reducing size of the scanned document.

The bids will be accepted in respect of those contractors having successfully completed with at least one work of value not less than Rs. 9.95 lakh or two similar works, each of value not less than Rs. 6.22 lakh or three similar works, each of value not less than Rs. 4.97 lakh during the last 7 years ending 31<sup>st</sup> August, 2020. Similar works means "Working experience of Civil works in Government organizations, Govt. Autonomous organizations OR Public limited Company / organizations. Experience in Pvt. Limited Companies and Societies not accepted.

Intending tenderers must upload self-attested copies of completion certificates and work orders of having completed the work satisfactorily issued by an appropriate competent authority. As per notification no.F.9/4/2020-PPD dated 12.11.2020 issued by Ministry of Finance, Department of Expenditure, Govt. of India, all the bidders have to submit "Bid Security Declaration" accepting that if they withdraw or modify their bids during period of validity etc., they will be suspended for the time specified in the tender documents.

Any Corrigendum/Amendments in respect of above tender shall be issued on IUAC website [www.iuac.res.in](http://www.iuac.res.in) and website <https://eprocure.gov.in> only. Bidders should take into account any corrigendum published on the tender document before submitting their bids.

The Director, IUAC reserves the right to accept/reject any/all tenders in part/full without assigning any reasons thereof.

Administrative Officer (S&P)

## TENDER FORM

To

The Director  
IUAC,  
Aruna Asaf Ali Marg,  
New Delhi 110067

Dear Sir,

I/We have read and examined the following Tender Documents relating to the MS platform cum connecting corridor with door openings from R. No. 111 Main Lab Building (Proposed FEL Control Room) to BH III G.Floor (towards FEL Lab) in IUAC Campus at Inter-University Accelerator Centre, Aruna Asaf Ali Marg, New Delhi -110067

- General information
- **MEMORANDUM**
- REGISTRATION PROCESS ON CPP PORTAL FOR ONLINE BIDDING, SEARCHING FOR TENDER DOCUMENTS , PREPARATION OF BIDS , SUBMISSION OF BIDS & ASSISTANCE TO BIDDERS
- Instructions for Online Bid Submission
- Scope of work
- General TERMS & Conditions
- Special Terms and conditions of Contract
- Drawing
- Annexure I & II
- Price Bid

I/We hereby offer to execute the work complete in all respects specified in the underwritten Memorandum within the time specified therein, at the rates specified in the Price Bid and in accordance with the specifications, designs, drawings and instruction in writing referred to in the condition of tender.

**Tenderers Signature and Seal**

## GENERAL INFORMATION

- |    |                                                       |                                                                                                                                                                                                                                                                                                                                          |
|----|-------------------------------------------------------|------------------------------------------------------------------------------------------------------------------------------------------------------------------------------------------------------------------------------------------------------------------------------------------------------------------------------------------|
| 1  | Accepting Authority                                   | Director, IUAC<br><b>New Delhi.</b>                                                                                                                                                                                                                                                                                                      |
| 2  | Reference Book                                        | As per specifications                                                                                                                                                                                                                                                                                                                    |
| 3  | Performance Security                                  | The successful bidder shall be required to deposit an amount equal to 3% of the tendered value of the contract as Performance Security within the period prescribed for commencement of work in the letter of award issued to him. Performance security may be accepted as Bank Guarantee/DD of Scheduled Banks and State Bank of India. |
| 4  | Authority competent to grant extension of time        | Director or authorized person by Director,                                                                                                                                                                                                                                                                                               |
| 5  | Tools & plants                                        | To be arranged by contractor                                                                                                                                                                                                                                                                                                             |
| 6  | Schedule of Minimum wages                             | As per notification issued by Govt. of NCT.                                                                                                                                                                                                                                                                                              |
| 7  | Authority competent to reduce the compensation amount | Director , IUAC                                                                                                                                                                                                                                                                                                                          |
| 8  | Defect Liability Period                               | Twelve (12) months from the date of acceptance of completion by the Institute.                                                                                                                                                                                                                                                           |
| 9  | Release of Performance Security Deposit               | The performance security shall be refunded to the contractor after successful completion of the work in all respects.                                                                                                                                                                                                                    |
| 10 | Authority Competent to Appoint Arbitrator             | Director, IUAC                                                                                                                                                                                                                                                                                                                           |

**(Seal & Signature of bidder)**

**MEMORANDUM**

- a) Name of work *MS platform cum connecting corridor with door openings from R. No. 111 Main Lab Building (Proposed FEL Control Room) to BH III G.Floor (towards FEL Lab).*
- b) Estimated cost Rs. 12,44,000/- (Rupees Twelve lacs Forty four thousand only)
- c) Time allowed for the completion of work (to be reckoned from 10<sup>th</sup> day after the date of issue of written order to commence work) 90 Days

**Place  
Date:**

**(Seal & Signature of bidder)**

### **REGISTRATION PROCESS ON CPP PORTAL FOR ONLINE BIDDING**

- 1** Bidders are required to enroll on the e-Procurement module of the Central Public Procurement Portal (URL: <https://eprocure.gov.in/eprocure/app>) by clicking on the link “**Online Bidder Enrolment**” on the CPP Portal which is free of charge.  
**Bidder who registered already may skip the registration process and login to site through their user ID/Password**
- 2** As part of the enrolment process, the bidders will be required to choose a unique username and assign a password for their accounts.
- 3** Bidders are advised to register their valid email address and mobile numbers as part of the registration process. These would be used for any communication from the CPP Portal.
- 4** Upon enrolment, the bidders will be required to register their valid Digital Signature Certificate (Class II or Class III Certificates with signing key usage) issued by any Certifying Authority recognized by CCA India (e.g. Sify / nCode / eMudhra/ Nic etc.), with their profile.
- 5** Only one valid DSC should be registered by a bidder. Please note that the bidders are responsible to ensure that they do not lend their DSC’s to others which may lead to misuse.
- 6** Bidder then logs in to the site through the secured log-in by entering their user ID / password and the password of the DSC / e-Token.

### **SEARCHING FOR TENDER DOCUMENTS**

- 1** There are various search options built in the CPP Portal, to facilitate bidders to search active tenders by several parameters. These parameters could include Tender ID, Organization Name, Location, Date, Value, etc. There is also an option of advanced search for tenders, wherein the bidders may combine a number of search parameters such as Organization Name, Form of Contract, Location, Date, Other keywords etc. to search for a tender published on the CPP Portal.
- 2** Once the bidders have selected the tenders they are interested in, they may download the required documents / tender schedules. These tenders can be moved to the respective ‘My Tenders’ folder. This would enable the CPP Portal to intimate the bidders through SMS / e-mail in case there is any corrigendum issued to the tender document.
- 3** The bidder should make a note of the unique Tender ID assigned to each tender, in case they want to obtain any clarification / help from the Helpdesk.

### **PREPARATION OF BIDS**

- 1** Please go through the tender advertisement and the tender document carefully to understand the documents required to be submitted as part of the bid. Please note the number of covers in which the bid documents have to be submitted, the number of documents - including the names and content of each of the document that need to be submitted. Any deviations from these may lead to rejection of the bid.

- 2 Bidder, in advance, should get ready the bid documents to be submitted as indicated in the tender document / schedule and generally, they can be in PDF / XLS / RAR / DWF/JPG formats. Bid documents may be scanned with 100 dpi with black and white option which helps in reducing size of the scanned document.
- 3 To avoid the time and effort required in uploading the same set of standard documents which are required to be submitted as a part of every bid, a provision of uploading such standard documents (e.g. PAN card copy, GST Certificate etc.) has been provided to the bidders. Bidders can use “My Space” or “Other Important Documents” area available to them to upload such documents. These documents may be directly submitted from the “My Space” area while submitting a bid, and need not be uploaded again and again. This will lead to a reduction in the time required for bid submission process.

Note: Bidder should take into account any corrigendum published on the tender document before submitting their bids.

### **SUBMISSION OF BIDS**

1. The tender shall be submitted online in two parts, viz., Technical bid and Financial bid.
2. The offers submitted by hand/Post/Fax/email shall not be considered. No correspondence will be entertained in this matter.
3. All the pages of bid being submitted must be sequentially numbered by the bidder irrespective of nature and content of the documents before uploading.
4. The bidders are required to submit soft copies of their bids electronically on the CPP Portal, using valid Digital Signature Certificates. The instructions given below are meant to assist the bidders in registering on the CPP Portal, prepare their bids in accordance with the requirements and submitting their bids online on the CPP Portal.
5. Bidder should log into the site well in advance for bid submission so that they can upload the bid in time i.e. on or before the bid submission time. Bidder will be responsible for any delay due to other issues.
6. The bidder has to digitally sign and upload the required bid documents one by one as indicated in the tender document.
7. Bidders are requested to note that they should necessarily submit their financial bids in the format provided and no other format is acceptable. If the price bid has been given as a standard BoQ format with the tender document, then the same is to be downloaded and to be filled by all the bidders. Bidders are required to download the BoQ file, open it and complete the white coloured (unprotected) cells with their respective financial quotes and other details (such as name of the bidder). No other cells should be changed. Once the details have been completed, the bidder should save it and submit it online, without changing the filename. If the BoQ file is found to be modified by the bidder, the bid will be rejected.

8. The server time (which is displayed on the bidders' dashboard) will be considered as the standard time for referencing the deadlines for submission of the bids by the bidders, opening of bids etc. The bidders should follow this time during bid submission.
9. All the documents being submitted by the bidders would be encrypted using PKI encryption techniques to ensure the secrecy of the data. The data entered cannot be viewed by unauthorized persons until the time of bid opening. The confidentiality of the bids is maintained using the secured Socket Layer 128 bit encryption technology. Data storage encryption of sensitive fields is done. Any bid document that is uploaded to the server is subjected to symmetric encryption using a system generated symmetric key. Further this key is subjected to asymmetric encryption using buyers/bid opener's public keys. Overall, the uploaded tender documents become readable only after the tender opening by the authorized bid openers.
10. The uploaded tender documents become readable only after the tender opening by the authorized bid openers.
11. Upon the successful and timely submission of bids (i.e. after Clicking "Freeze Bid Submission" in the portal), the portal will give a successful bid submission message & a bid summary will be displayed with the bid no. and the date & time of submission of the bid with all other relevant details.
12. The bid summary has to be printed and kept as an acknowledgement of the submission of the bid. This acknowledgement may be used as an entry pass for any bid opening meetings.

### **ASSISTANCE TO BIDDERS**

1. More information useful for submitting online bids on the CPP Portal may be obtained at: <https://eprocure.gov.in/eprocure/app>.
2. Any queries relating to the tender document and the terms and conditions contained therein should be addressed to the Tender Inviting Authority for a tender or the relevant contact person indicated in the tender.
3. Any queries relating to the process of online bid submission or queries relating to CPP Portal in general may be directed to the 24x7 CPP Portal Helpdesk. The contact number for the helpdesk is 1800 3070 2232, 91-7878007972 and 91-7878007973.

### **Instructions for Online Bid Submission**

- 1 The tender documents are available on our website [www.iuac.res.in](http://www.iuac.res.in) & [www.eprocure.gov.in](http://www.eprocure.gov.in).
- 2 Tender documents may be downloaded from IUAC's website [www.iuac.res.in](http://www.iuac.res.in) and CPPP site <https://eprocure.gov.in/eprocure/app> as per the schedule as given in the tender document.
- 3 Bids shall be submitted online only at CPPP website: <https://eprocure.gov.in/eprocure/app>. Tenderers/Contractors are advised to follow the instructions provided in the 'Instructions to the Contractors/Tenderer for the e-submission of the bids online through the Central Public Procurement Portal for eProcurement at <https://eprocure.gov.in/eprocure/app>'. Bid documents may be scanned with 100 dpi with black and white option which helps in reducing size of the scanned document.

- 4 Not more than one tender shall be submitted by one contractor or contractors having business relationship. Under no circumstance will father and his son(s) or other close relations who have business relationship with one another (i.e. when one or more partner(s)/director(s) are common) be allowed to tender for the same contract as separate competitors. A breach of this condition will render the tenders of both parties liable to rejection.
- 5 The bidders are advised to visit CPPP website <https://eprocure.gov.in/eprocure/app> at least 3 days prior to closing date of submission of tender for any corrigendum / addendum/ amendment.
- 6 Bids will be opened as per date/time as mentioned in the **Tender Document**. After online opening and evaluation of technical bids, the results of their qualification as well Price-Bid opening will be intimated.
- 7 Submission of a tender by a tenderer implies that he has read all the stipulations contained in this tender document and has acquainted him of the nature, scope and specifications of the items to be followed.
- 8 The tenderer shall submit all documents after duly filling the same in all respects. Tenders which are found to be vague or incomplete shall be rejected summarily.
- 9 Tenders shall be submitted ON-LINE, it shall be signed by one who has been authorized by the board of director /director / manufacture/ firm owner /their authorized agents through a resolution/ authority letter. Copy of the resolution/ authority letter in favour of the person signing must accompany the tender.
- 10 Tenders containing erasures and alterations of the tender documents are liable to be rejected unless these are authenticated by the person signing the Tender Documents.

**Tenderers Signature with Seal**



### **SCOPE OF WORK:**

The Scope of works include the works of ' MS platform cum connecting corridor with door openings from R. No. 111 Main Lab Building (Proposed FEL Control Room) to BH III Ground Floor (towards FEL Lab) ' with following subhead /item execution as per detailed scope of tender document , drawing as well as BOQ .

- (i) Making opening for door provision in Brick wall of R.No 111 (proposed FEL control room) of Main Lab Building
- (ii) Making opening for door provision in brick work of Beam Hall III 'S' brick wall
- (iii) P/F M.S Stairs cum landing inside of Beam Hall to connect the stair with existing steps towards BH-III Basement (towards FEL Lab)
- (iv) P/F a M.S Platform cum connecting corridor to connect R.No 111 (proposed FEL control room) & Beam Hall III's brick wall (FEL Lab)
- (v) Misc. civil works (such as painting /finishing of surrounding area )

Electric supply and water, if any, required for the execution of work shall be provided by institute from one point free of cost.

### **GENERAL TERMS & CONDITIONS**

**1** **Submission of Tender:** Tenders should be uploaded on CPP portal in two parts separately, i.e. "Technical Bid" (Part-A) and "Price Bid / BOQ)" (Part-B). No other mode of submission will be accepted.

**Any clarifications/amendments/corrigenda etc., to NIT before last date of submission of bid will only be available on our website: [www.iuac.res.in](http://www.iuac.res.in). Therefore bidders are advised to keep visiting our website.**

**2** **(I) Technical Bid (Part-A) :** In this bid, the bidder shall upload the scan copies of the following: **The following essential documents are required for Technical Qualification:**

- i** Covering letter on Company's Letter Head
- ii** Bio data of company (Company profile, organizational setup, credentials, list of plant, machinery & tools in his possession).
- iii** Copy of the audited balance sheet / turnover certificate of the past three financial years ending 31/03/2020.
- iv** Copies of PAN no., GST Reg. no.
- v** Copies of work orders and completion certificates of similar type of works (similar type means **civil work**) executed successfully during the last 7 yrs. (ending on the last day of submission of bids) in Govt., Public sector, Autonomous body or reputed Public Ltd. Company, with at least one work of value not less than Rs. 9.95 lakh or two similar works, each of value not less than Rs. 6.22 lakh or three similar works, each of value not less than Rs. 4.97 lakh. Experience in Pvt. Limited Companies and Societies not accepted.
- vi** **Tender acceptance letter (as per annexure - I of tender document) on bidder's letter**

head duly signed & stamped by the bidder as acceptance of all terms & condition of tender.

- vii Undertaking for Site Visit has to be submitted as per Annexure – II & Bid Security Declaration

**(ii) Price Bid (Part-B):** In this bid, the bidder is required to quote his item rates in the BOQ formed in accordance with the scope of work, terms & conditions & technical specifications enclosed. The rates/price quoted by contractor should be all inclusive i.e. should include all material cost, labour, services, plant/machinery/tools & tackles, ladders & scaffolding required for work, freight, Insurance, and all applicable Govt. Duties, **including GST (payable separately as/if applicable )** , levies & taxes, transport/cartage of materials/labour and all other expenses not specifically mentioned but reasonably implied. Nothing over and above these rates shall be payable to contractor.

However if any fresh taxes are imposed by State/Central/Statuary bodies during the currency of contract, the same shall be borne by Institute.

Further, nothing extra in rates will be considered due to any site difficulties. It is mandatory for bidder to quote all items rate as asked for in the BOQ/ PRICE schedule. Failure in not filling some item rates will lead to be considered them as zero and accepted .No further compensation on that item can be considered later. The bidders should quote unconditional rates.

3. **Validity of Tender:** Tender shall be valid for our acceptance without any change in rates and NIT conditions for a period of 90 days from the date of opening of Technical bid. No tenderer can withdraw/or modify his tender or revoke the same within the said period of 90 days. If a tenderer on his withdraws or revokes the tender or revises or alters or modifies the tender for any item or condition within a period of aforesaid 90 days.

The validity of accepted rates is extendable for a period of 180 days from the date of issue of Award Letter, with mutual consent of both the parties.

4. **Escalation:** No escalation over and above items rates quoted by the bidder shall be paid during the execution of contract.

5. **Performance Bank Guarantee:** The successful bidder has to submit a performance bank guarantee /FDR of an amount equal to 3% of total contract value within a period of 10 days from the date of issue of LOI. Performance Bank Guarantee shall be valid for a minimum period of 60 days beyond the date of completion. If tenderer fails to deposit the said performance security within the period as indicated, the order will be automatically cancelled without any notice to the tenderer and without prejudice to any other right or remedy.

6. **Completion time:** The time shall be the essence of this contract and entire work as titled above is to be completed in all respects within a period of 90 days. The time allowed for the completion of work to be reckoned from the 10<sup>th</sup> day after the date of issuance of award letter/purchase order. Any delay in completing the work for reasons attributable to the Contractor is liable for liquidated damages as per clause 14 of NIT. Under the force-majeure conditions, IUAC may grant suitable time extension without penalty for which the contractor has to request along with the

justification/ reasons well in advance to IUAC for approval without any prejudice to price escalation. No time extension request shall be considered after the expiry of completion period/contract. The decision of the Director, IUAC regarding Time extension will be final and binding on the contractor.

- 7. Deviations:** No deviation from the stipulated terms and conditions will be allowed. Tender will be unconditional.
- 8. Site Conditions:** Contractor shall acquaint himself fully with the site conditions and the working environment of IUAC before quoting his rates. No Compensation on account of any site difficulties will be entertained, at a later date, after award of the work. ( The bidder should signed undertaking as per Annexure –II enclosed in tender )
- 9. Correspondence:** All the correspondence in respect of tender/award of work shall be made to A.O. (S&P), IUAC, Aruna Asaf Ali Marg, New Delhi-110067.
- 10. Terms of Payment:** The payment shall be made on submission of the bills in proper format by the contractor after due certification by the IUAC engineer responsible for supervision of the work. Contractor can submit two interim or running bills and one final bill after completion of work for claiming payment based on actual quantities of items of work executed & measured as per BOQ, drawings and Engineer's site instructions.
- 11. Labour Laws:** The contractor will abide by all the rules and regulations related to labour laws, accident, workmen compensation act, workmen insurance etc. This will be the sole responsibility of the contractor. IUAC will not be a party at any stage in any of the disputes relating to the above. In case, IUAC has to bear any expenditure due to non-conformance of the above provisions by the contractor, the same will be recovered from contractor's bills.

Contractor will have his own arrangement to escort the labour to the nearest hospital for treatment in case any injury happens to any worker during execution.

**12. Rules governing the Contractor's employees working in the IUAC Premises:**

Contractor will take due permission for entry of all his workmen in IUAC. No unauthorized person will be allowed to work inside IUAC campus.

The contractor's employees working inside the IUAC campus will abide by the Centre's rules & regulations for works inside the campus. Any damage to the IUAC property due to mishandling, carelessness on the contractor's or his workmen's part will be recoverable from the contractor's bills.

Manpower deployed by the contractor at site for carrying out contract work is strictly prohibited being associated with any other works on the campus.

**13. Liquidated damages:** In case the work is delayed beyond the specified completion period for

reasons attributable to the contractor, deductions on account of Liquidated damages @1 % of the contract value per week will be deducted subject to a maximum of 10 % of the contract value . However, during the delayed period, IUAC also reserves the right to get balance portion of work done by any other contractor at the risk and cost of the existing contractor and amount to that effect along with 10% overhead charges will be deductible from his bills/dues.

**15 Extra or substituted item-** If any extra or substituted item appears in the work, contractor shall submit its rate analysis supported with documents which shall be approved by IUAC. If required, IUAC can make its own analysis based on DSR document of CPWD or based on market rates for determining item rate and pay to contractor accordingly.

**16 Defect Liability period:** Defect liability period shall be one year from the date of completion of work. Any defect arising in this period due to contractor's fault will be rectified by him at his own cost. Failure to do so shall lead to forfeiture of security deposit.

#### 18 . **FORCE MAJEURE:**

The right of the contractor to proceed with the work shall not be terminated because of any delay in the completion of the work due to unforeseeable causes beyond the control and without the fault or negligence of the contractor, including not limited to acts of God, or of the public enemy, restraints of a sovereign state, firms, floods, unusually severe weather.

#### 19. **JURISDICTION:**

Notwithstanding any other courts having jurisdiction to decide the questions forming subject matter of a suit any and all actions and proceedings arising out of or relative to this contract (including any arbitration in terms thereof) shall lie only in the court of competent Civil jurisdiction in this behalf at New Delhi., where this contract is to be signed on behalf of and only the said court shall have jurisdiction to try any such actions and/or proceedings to the exclusion of all other courts.

**20. TENDERER TO SATISFY HIMSELF OF SITE CONDITIONS:** Tenderers are advised to inspect and examine the site and its surroundings and satisfy themselves before submitting their tender regarding nature of the site conditions, the means of access of the site, the accommodation they may require and in general obtain all necessary information as to risks, contingencies and other circumstances which may influence or affect their tender in any manner. A tenderer shall be deemed to have full knowledge of the site, whether he inspects it or not and no compensation or otherwise of any charges incurred or to be incurred consequent on any misunderstanding or otherwise shall be admissible.

**21. SAMPLES:** After award of work of the tender contractor shall show the relevant samples at his own cost to Institute before start of work. These samples will be sealed by the IUAC in the presence of the contractor, if he so desires and shall remain in the custody of the IUAC for reference and comparison till the completion of work.

**22. TENDER LIABLE TO REJECTION:** Tenders which do not fulfill all or any of the conditions laid down in this notice, or contain conditions not covered and / or not contemplated by the Conditions of tender document and/or expressly prohibited therein or stipulate additional/alternative conditions shall be liable to be rejected and his earnest money will be forfeited. Tenders shall also be liable for rejection on any of the following grounds:-

- i) Tenders containing remarks uncalled for.
- ii) Conditional tenders

- iii) Tenders not submitted on prescribed Performa.
  - iv) Telegraphic / Fax/ Postal tenders.
  - v) Tender submitted without tender fee and EMD.
  - vi) Tenders submitted late
  - vii) Tenders with NIL consideration
  - viii) Not submitted required documents as per tender
23. **CORRESPONDENCE:** Tender must mention their postal address and telephone number(s) of the Chief Executive/authorized agent or attorney in the tender. The tender submitted by the tenderer will be rejected if he or his agent cannot be contacted on the last known address or on the intimated telephone number(s) after reasonable search in which event earnest money may be forfeited by the IUAC.
24. **IUAC NOT TO ASSIGN ANY REASON FOR REJECTION OF TENDER:** Director, IUAC hold absolute discretion to accept or reject the lowest or any other tender without assigning any reason. No claim on this account shall be entertained.
25. **AMENDMENT IN TENDER DOCUMENTS:** IUAC reserve the right to revise or amend the Bid Documents upto the date prior to the date notified for opening of the tenders and also the right to postpone the date of submission and opening of tenders without assigning any reason, whatsoever.
26. IUAC will not pay any expense, whatsoever incurred by tenderer for the preparation and submission of tenders.
27. IUAC does not bind itself to accept the lowest or any tender and reserves the right to reject any of all tenders without assigning any reason.
28. The notice inviting tender, will form part of the contract agreement to be executed by the successful tenderer with the IUAC.
29. **IUAC also reserves the right to change the quantities of the units while issuing the letter of award of work.**
30. **REFERENCE IN TENDER DOCUMENTS:** Director, IUAC, shall be refereed as "Owner" in all the documents of Tender documents/contract agreement.
31. **OFFICER INCHARGE:** Where ever the word "Incharge" occurs it shall mean the authorized Officer appointed by the IUAC for the superintendence of the execution or related work.

## **SPECIAL TERMS AND CONDITIONS OF CONTRACT /WORK**

### **1. CARRYING OUT OF WORK**

All the work shall be carried out in accordance strictly as per the specifications given in the tender to the total satisfaction of the Institute. In the case of an item for which specification are not available in the said specifications relevant to BIS /CPWD specifications applicable as on the date of tenders shall be followed.

The works shall be inspected by our IUAC Engineers or the person nominated by the Director IUAC. The contractor shall extend full co-operation and render all necessary facilities for inspection of the work to the inspecting authority without any additional cost to IUAC. It must be noted that any observations/ comments/ recommendations of the said Technical consultants shall be binding on the contractor.

### **2. CONTRACTOR'S RESPONSIBILITY FOR THE MANNER OF EXECUTION OF WORKS**

The contractor shall be solely responsible for the manner and the method of executing the work. The work shall be subject to the approval of IUAC from time to time for purposes of determination of the question whether the work is executed by the contractor in accordance with the contract.

### **3. NO WORK SHALL BE UNDERTAKEN WITHOUT APPROVED WORKING DRAWINGS:**

No work shall be undertaken at site by the contractor until detailed approved working drawings marked "Good" for execution/construction is issued by the IUAC in writing. Any work done without the aforesaid working drawing shall be at the contractor's own risk and costs.

### **4. SPECIFICATIONS:**

During execution of work, the contractor should follow all standard norms of safety measures/precautions as per relevant IS codes and CPWD specifications to avoid accidents/damages to man, machines and buildings, at his own cost.

If specifications for an item of work are not covered as per approved Specifications of tender, the same shall be decided by the Institute and shall be binding on the contractor.

The Director shall have the power to insist upon the contractor to purchase and use such materials of approved make which may in his opinion be necessary for proper and reasonable compliance with the specifications and execution of work.

In the event of any variation/discrepancy in the drawings, specification and tender documents the decision of the Institute shall be final binding and conclusive on the contractor.

a) As required by IUAC, or his representative, the contractor shall provide all facilities at site or at manufacturer's works or an approved laboratory for testing of materials and/or workmanship. All

the expenditure in respect of this shall be borne by the contractor wherever applicable. The contractor shall, when required to do so by IUAC, submit manufacturer's certificate that the materials have been tested in accordance with requirements of the specifications.

b) Neither the omission by IUAC, to test neither the materials nor the production of manufacturer's certificate etc., as aforesaid shall affect the right of the IUAC to reject after delivery the materials found not in accordance with the specifications.

#### **5. ADDITIONS/ALTERATIONS/ DEVIATIONS**

The IUAC, shall have power to make any alterations or omissions or additions or substitutions in the original specifications ,drawings ,designs and instructions that may appear to him to be necessary or advisable during the progress of the work, and the contractor shall be bound to carry out the work in accordance with any instructions which may be given to him in writing signed by the IUAC and such alterations, additions or substitutions shall not invalidate the contract and any altered, additional or substituted work which the contractor may be directed to carry out in the manner above specified as part of the work shall be carried out by the contractor on same conditions in all respects on which he agreed to do the main work. The time for the completion of the work shall be extended in the proportion that the altered additional or substituted work has to the main work at the sole discretion of the IUAC, and his decision in this regard shall be final and binding on the contractor.

All tenderers are required to quote as per specifications stipulated hereunder. Rates for all items shall be quoted as specified hereunder. After the award of the contract, the work shall be carried out as per approved samples / drawings. For dimensional variation + - 1 inch may be considered at the completion stage, there shall not be any rate difference. If the dimensional changes are more than the above limit, modified rates shall be worked out derived from the quoted contract rates. Rates for extra/substituted items, should they became necessary during the execution of he work shall be settled on analysis of rate to be submitted by the contractor for such items.

Quantities in the B.O.Q. or estimated quantities which can vary up to  $\pm 25\%$  during the execution of the work. Payment shall be made as per actual quantities executed without any change in the contracted rate due to variation in quantity, if any.

#### **6. QUALITY CONTROL OF MATERIAL**

If it shall appear to the Engineer or the Director , that any work has been executed with unsound, imperfect, or unskillful workmanship or with materials or articles provided by him for the execution of the work are unsound, or of a quality inferior to that contracted for or otherwise not in accordance with contract, the contractor shall on demand in writing from the Engineer specifying the work materials or articles complained of notwithstanding that the same may have been inadvertently passed ,certified and paid for forthwith rectify, or remove & reconstruct the work so specified in whole or in part ,as the case may require, or as the case may remove the materials or articles so specified and provide other proper and suitable material or articles at his own charge and cost and in the event of his failing to do so within a period to be specified by Engineer, in his demand as aforesaid then the contractor shall be liable to pay compensation at the rate of 1% on the contract agreement of work for everyday till rectify or remove, and re-execute the work or replace with other materials or articles complained of as the case may be at the risk and expense in all respects of the contractor.

**7. . SITE WORKING RULES AND REGULATIONS:**

- a) The contractor shall furnish IUAC, the Power of Attorney name and signature of his authorized representative who will be in-charge of the execution of the works at site. The contractor shall also furnish the list of technically qualified persons employed by him for execution of the works.
- b) Save as otherwise specifically provided in this Agreement the rates and prices herein, unless otherwise stipulated elsewhere in this Agreement, include all the costs, expenses and outlays of the contractor for executing the works and fulfilling all the obligations of the Contractor under this agreement.

**8. INSPECTION OF WORK**

All work under or in course of execution or executed in pursuance of the contract shall at all times be open to the inspection and supervision of Engineer, or his subordinate in-charge of the work and the contractor shall at all times, during the usual working hours and at all other times at which reasonable notice of the intention of the Engineer to visit the works shall have been given to the contractor, either himself be present to receive order and instructions or have a responsible agent/supervisor duly accredited in writing present for that purpose. Orders given to the contractor's agent/ supervisor shall be considered to have the same force as if they had been given to the contractor himself.

The work during its progress shall be inspected by the Engineer or Engineer-in-charge on behalf of and the contractor shall extend all co-operations to the engineers inspecting the work.

**9. AGENCY'S RISKS**

All risks of loss of a or damage to physical property and of personal injury and death which arise during and in consequence of the performance of the contract other than the excepted risks are the responsibility of the contractor.

**10. ACTION AND COMPENSATION PAYABLE IN CASE OF BAD WORK:**

If it shall appear to IUAC, or our representatives, that any work has been executed with unsound, imperfect or unskillful workmanship or with materials of any inferior description or that any materials or articles provided by him for the execution of the work are unsound or of a quality inferior to the contracted for, or otherwise not in accordance with the contract and provide other and suitable materials or articles so specified at his own cost and in the event of his failing to do so within a period to be specified by the IUAC in his demand aforesaid, **then the contractor shall be liable to pay compensation at the rate of one percent on the amount of the work order** for every week not exceeding ten days while his failure to do so that continue and in the case of any such failure IUAC, may rectify or remove, and re-execute the work or remove and replace with other materials or articles complained of, as the case may be at risk and expenses in all respects of the contractor.

**11.** Contractor should depute a technically qualified supervisor dedicated for this work, who will monitor and coordinate work from contractor's side and interact with the IUAC Engineers, responsible for supervision of work, on regular basis.

**12.** The contractor will arrange all necessary materials, tools, equipment, access ladders & scaffolding, measuring instruments and working consumables etc. needed for execution of the works. Safe custody of all such material will be contractor's sole responsibility. No extra charges will be paid for the same. Watch and ward of all material till the system is taken over by IUAC shall be the sole responsibility of the contractor and pilferage etc. shall be entirely to his account.



- 13.** If during the execution of works, any damage is caused to IUAC property by contractor's workers, contractor will duly make good the loss. IUAC has the right to make suitable deduction from contractor's bills along with penalty, if contractor fails to make good the loss.
- 14.** No material belonging to the contractor whether consumable or non-consumable should be brought inside the IUAC campus without proper entry at the Main Gate nor any material should be taken out without proper gate pass issued by the authorized representatives of the Centre. Material delivery challans duly entered at the main gate shall to be submitted.
- 15.** During execution of the work, contractor should dispose-off waste material on regular basis and should keep the area of work properly cordoned off and neat and clean as far as possible. After completion of work, contractor should clear the site completely of all unwanted and junk material before submitting his final bill.
- 16.** It shall always prevail, unless otherwise specifically stated, that the entire provisions of Tender document been opened upon and accepted for compliance by the contractor without any reservation.
- 17.** During execution of work, Engineer can make minor changes in the scope of work as per site conditions or other reasons. Contractor will have no extra claim in his rates for the same.
- 18.** If during the execution of works, any damage is caused to IUAC property by contractor's workers, contractor will duly make good the loss. IUAC has the right to make suitable deduction from contractor's bills along with penalty, if contractor fails to make good the loss.
- 19.** During execution of work, the contractor should follow all standard norms of safety measures/precautions as per relevant IS codes and CPWD specifications to avoid accidents/damages to man, machines and buildings, at his own cost. Contractor will have his own arrangement to escort the labour to the nearest hospital for treatment in case any injury happens to any worker during execution of work.
- 20.** Contractor will use only approved makes of materials as listed below and will get the samples of these materials approved by IUAC Engineer before incorporating in the work.
- 21.** Payment for executed work will be made to contractor based on actual measurement only.

**Seal & Signature of Contractor**

## LIST OF APPROVED MAKES

1. Structural MS Section/ Extruded Section /Plates :Tata,Jindal,Rana,Mahabir,Baarnala,Sail, Capital
2. Hot finished welded, seamless Hollow Tube: Tata ,Jindal ,Wellspun ,TTT ,Sandeep Steel
3. Aluminium Sections : Jindal ,Hindalco ,Indal & Mahavir
4. Hydraulic Door closer : Hardwyn ,Johnson ,Dorset ,Godrej
5. Acrylic / Oil bound distemper : Shlimar, Asian, Nerolac, Jenson & Nicholson, Berger
6. Premium Acrylic Emulsion Paint : Shalimar, Asian,Nerolac, Jenson & Nicholson, Berger,
7. Enamel paint: : ..... Do .....
8. Cement Primer : ..... Do .....
9. Adhesive (for mixing in whitewash) : DDL(M/S Pidlite), SDL(M/S Chemisol) , Mastercreeet(M/S Choksey)
10. Wall Putty (cement based) : Birla, JK, Sakrani ,Asian
11. Admixture for bonding : Pidilite , Parex , Chemisol , Choksey
12. Block Board & Ply wood : Kitply,Green Ply,Minimax,Cooma ,Centuary & Duro
13. Door /cupboard locks : Godrej ,Dorset & Harrison
14. Flush Door : Century Ply Board ,Duro ,Alpro ,Minimax ,Green-ply & Jain Door
15. S.S tube : Jindal , Ratanmani ,Suraj,Oshwin,MBM
16. Cement: O.P.C. /P.P.C. confirming to IS: 1489 – ACC, Birla, Ambuja, Jaypee & J.K. Cement.
17. ACP Cladding Board : VIVA ,Aludecor, Eurobond ,Wonder ,Alstrong Deltyn

DRAWING

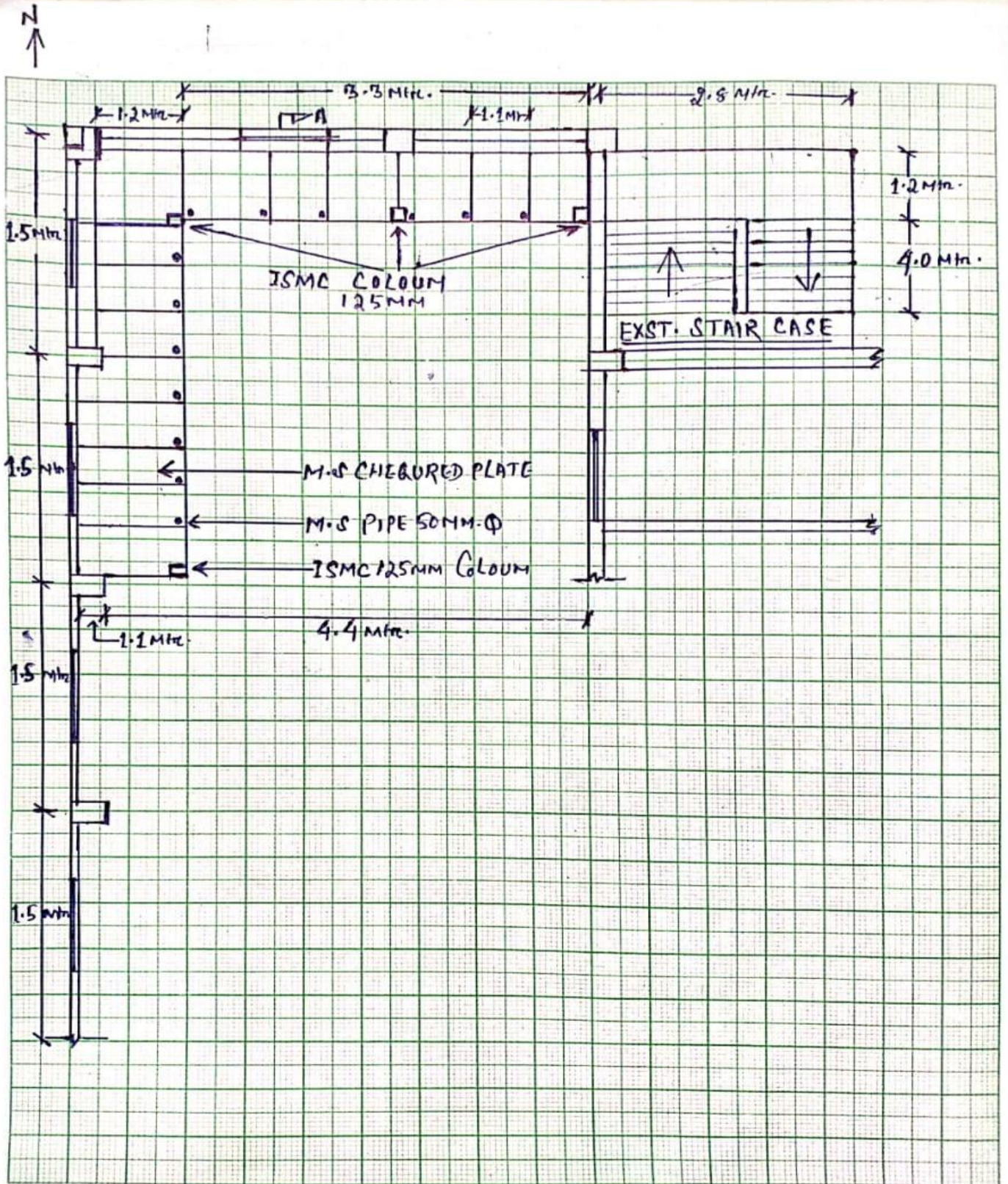

**PLAN: PROPOSED MS CONNECTING CORRIDOR FROM R.NO 11 1 MAIN LAB**

## BUILDING to BH III G. Floor

### ANNEXURE 1

TENDER ACCEPTANCE LETTER (To be given on Bidders/ Company Letter Head)

Date: \_\_\_\_\_

To

The Administrative Officer (S&P)  
Inter-University Accelerator Centre  
Aruna Asaf Ali Marg  
New Delhi-110 067.

Sub: Acceptance of Terms & Conditions of Tender.

Tender Reference No: \_\_\_\_\_

Name of Tender / Work: \_\_\_\_\_

Dear Sir,

1. We have downloaded / obtained the tender document(s) for the above mentioned 'Tender/Work' from the web site(s) namely: ..... as per your advertisement, given in the above mentioned website(s).
2. We hereby certify that we have read the entire terms and conditions of the tender documents from Page No. \_\_\_\_\_ to \_\_\_\_\_ (including all documents like annexure(s), schedule(s), etc .), which form part of the contract agreement and we shall abide hereby by the terms / conditions / clauses Contained therein.
3. The corrigendum(s) issued from time to time by your department/ organizations too have also been taken into consideration, while submitting this acceptance letter.
4. We hereby unconditionally accept the tender conditions of above mentioned tender document(s) / corrigendum(s) in its totality / entirety.
5. We do hereby declare that our Firm has not been blacklisted/ debarred by any Govt. Department/ Public sector undertaking.
6. We certify that all information furnished by the our Firm is true & correct and in the event that the information is found to be incorrect/untrue or found violated, then your department/ organization shall without giving any notice or reason therefore or summarily reject the bid or terminate the contract, without prejudice to any other rights or remedy including the forfeiture of the full said earnest money deposit absolutely.

Yours Faithfully,

(Signature of the Bidder, with  
Official Seal)

This certificate shall be furnished duly signed & stamped with **Techno-commercial Bid.**  
**Annexure - II**

**Certificate/ Undertaking**

This is to certify that we have visited the site where **MS platform cum connecting corridor with door openings from R. No. 111 Main Lab Building (Proposed FEL Control Room ) to BH III G.Floor (towards FEL Lab)** works have to be done in IUAC lab complex on ..... and assessed the actual situation & nature of site. We have also assessed the amount of work involved at site for tendered work before submitting our offer. We will be able to complete the above work within stipulated time as per site conditions.

We further undertake that no extra cost will be claimed by us later-on for any difficulties/ modifications involved during the execution of tendered works. We understand that work is to be executed in an already operational/ functional institute.

**(Signature of the Bidder, with Official Seal)**

**BOQ/PRICE BID**

(Price should be quoted in the standard BOQ format of this tender, Incomplete price bid will be rejected)

**Tender Inviting Authority:** INTER UNIVERSITY ACCELERATOR CENTRE

**Name of Work/Supply:** MS platform cum connecting corridor with door openings from R. No. 111 Main Lab Building (Proposed FEL Control Room ) to BH III G.Floor (towards FEL Lab)

| <b>Bill of Quantities</b> |                                                                                                                                                                                                                                                                                                                                                                                                                                                                                                                                                                                                                                                                                                                                                                                                                                                                                                                                                                               |       |      |
|---------------------------|-------------------------------------------------------------------------------------------------------------------------------------------------------------------------------------------------------------------------------------------------------------------------------------------------------------------------------------------------------------------------------------------------------------------------------------------------------------------------------------------------------------------------------------------------------------------------------------------------------------------------------------------------------------------------------------------------------------------------------------------------------------------------------------------------------------------------------------------------------------------------------------------------------------------------------------------------------------------------------|-------|------|
| S.No                      | Description of Item                                                                                                                                                                                                                                                                                                                                                                                                                                                                                                                                                                                                                                                                                                                                                                                                                                                                                                                                                           | Unit  | Qty. |
| 1                         | Excavation work by mechanical means (Hydraulic excavator)/ manual means in foundation trenches or drains (not exceeding 1.5m in width or 10 sqm on plan), Ordinary rock ,including dressing of sides and ramming of bottoms, lift up to 1.5 m, including getting out the excavated soil and disposal of surplus excavated soils as directed, within a lead of 50 m.                                                                                                                                                                                                                                                                                                                                                                                                                                                                                                                                                                                                           | Cum   | 3.3  |
| 2                         | Steel work in built up tubular (round, square or rectangular hollow tubes (Electric resistance Induction butt welded ) etc.) trusses etc., including cutting, hoisting, fixing in position and applying a priming coat of approved steel primer and 2 coats of paint including welding and bolted with special shaped washers etc. complete.                                                                                                                                                                                                                                                                                                                                                                                                                                                                                                                                                                                                                                  | Kg    | 1800 |
| 3                         | Providing and fixing carbon steel galvanised ( minimum coating 5 micron) dash fastener of 10 mm dia ( 10 x 140 mm size) double threaded 6.8 grade (yield strength 480 N/mm2), counter sunk head, comprising of 10 mm dia polyamide PA 6 grade sleeve, including drilling of hole in frame , concrete/ masonry, etc. as per direction of Engineer-in-charge.                                                                                                                                                                                                                                                                                                                                                                                                                                                                                                                                                                                                                   | Each  | 200  |
| 4                         | Steel work welded in built up sections/ framed work, including cutting, hoisting, fixing in position In stringers, treads, landings etc. of stair cases, gratings, frames, guard bar, ladder, railings, brackets, gates and similar works including use of chequered plate wherever required, all complete and applying a priming coat of approved steel primer using structural steel etc. as required.                                                                                                                                                                                                                                                                                                                                                                                                                                                                                                                                                                      | Kg    | 3950 |
| 5                         | Providing & fixing 5.5 mm thick glass panes with putty and glazing clips in steel doors, windows, clerestory windows, all complete                                                                                                                                                                                                                                                                                                                                                                                                                                                                                                                                                                                                                                                                                                                                                                                                                                            | Sqmtr | 8    |
| 6                         | Providing, fabricating and supplying and fixing in position Curtain Wall with Aluminium Composite Panel Cladding, of 4mm thick aluminium composite panel material consisting of 3mm thick FR grade mineral core sandwiched between two Aluminium sheets (each 0.5mm thick) for all heights and all levels etc. including: The aluminium composite panel cladding sheet shall be coil coated, with Kynar 500 based PVDF / Lumiflon based fluoropolymer resin coating of approved colour and shade on face # 1 and polymer (Service) coating on face # 2 as specified using stainless steel screws, nuts, bolts, washers, cleats, weather silicone sealant, backer rods etc. Base frame work for ACP cladding is payable under the relevant MS items. For the purpose of payment, only the actual area on the external face of the curtain wall with Aluminum Composite Panel Cladding (including width of groove, if any ) shall be measured in sqm. up to two decimal places. | Sqmr  | 70   |



|    |                                                                                                                                                                                                                                                                                                                                                                                                                                                                                                                                                                                                                                                                                       |       |     |
|----|---------------------------------------------------------------------------------------------------------------------------------------------------------------------------------------------------------------------------------------------------------------------------------------------------------------------------------------------------------------------------------------------------------------------------------------------------------------------------------------------------------------------------------------------------------------------------------------------------------------------------------------------------------------------------------------|-------|-----|
| 7  | Providing and fixing stainless steel ( Grade 304) railing made of Hollow tubes, channels, plates etc., including welding, grinding, buffing, polishing and making curvature (wherever required) and fitting the same with necessary stainless steel nuts and bolts complete, i/c fixing the railing with necessary accessories & stainless steel dash fasteners , stainless steel bolts etc., of required size, on the top of the floor or the side of waist slab with suitable arrangement as per approval of Engineer-in charge, (for payment purpose only weight of stainless steel members shall be considered excluding fixing accessories such as nuts, bolts, fasteners etc.). | Kg    | 120 |
| 8  | Providing and fixing 9 mm thick Decorative plywood one side decorative veneer and commercial veneer on other face (Type 1) conforming to IS 1328 BWR Type for making panelled partition on wood with nail and frame                                                                                                                                                                                                                                                                                                                                                                                                                                                                   | Sqmtr | 70  |
| 9  | Providing and fixing on wall face unplasticised Rigid PVC rain water pipes, 110 mm diameter, Single socketed pipes. Conforming to IS: 13592 Type A, including jointing with seal ring conforming to IS: 5382, leaving 10 mm gap for thermal expansion, including required shoe, band (with /without door),coupler etc.                                                                                                                                                                                                                                                                                                                                                                | Rmtr  | 20  |
| 10 | 12 mm cement plaster finished with a floating coat of neat cement of mix 1:3 (1 cement: 3 fine sand)                                                                                                                                                                                                                                                                                                                                                                                                                                                                                                                                                                                  | Sqm   | 25  |
| 11 | Making the opening for door/ window/ clerestory window in brick masonry including dismantling in floor or walls by cutting masonry and making good the damages to walls, flooring and jambs complete, to match existing surface i/c disposal of malba/ rubbish to the nearest municipal dumping ground, all complete as per direction of Engineer-in-Charge.                                                                                                                                                                                                                                                                                                                          | Sqm   | 2   |
| 12 | Fixing door chowkhats in existing opening including embedding chowkhats in floors or walls cutting masonry for holdfasts, embedding hold fasts in cement concrete blocks of size 15 x 10 x 10 cm with cement concrete 1:3:6 (1 cement : 3 coarse sand : 6 graded stone aggregate 20 mm nominal size), painting two coats of approved wood preservative to sides of chowkhats and making good the damages to walls and floors as required complete, including disposal of rubbish to the dumping ground, all complete as per direction of Engineer-in-Charge.                                                                                                                          | Each  | 2   |
| 13 | Demolishing R.C.C. work manually/ by mechanical means including stacking of steel bars and disposal of unserviceable material within 50 metres lead as per direction of Engineer - in-charge.                                                                                                                                                                                                                                                                                                                                                                                                                                                                                         | cum   | 1.3 |
| 14 | Demolishing brick work In cement mortar manually/ by mechanical means including stacking of serviceable material and disposal of unserviceable material within 50 metres lead as per direction of Engineer-in-charge.                                                                                                                                                                                                                                                                                                                                                                                                                                                                 | Cum   | 6   |
| 15 | Providing and laying in position cement concrete of 1:1½:3 (1 Cement: 1½ coarse sand (zone-III) : 3 graded stone aggregate 20 mm nominal size) excluding the cost of centring and shuttering - All work up to plinth level                                                                                                                                                                                                                                                                                                                                                                                                                                                            | Cum   | 2   |
| 16 | Providing and laying gang saw cut 30 mm thick, With granite stone of area less than 0.50 sqm. mirror polished pre moulded and pre polished machine cut granite stone of required size and shape of approved shade, colour and texture in step and similar locations, laid over MS frame including grouting the joints with white cement mixed with matching pigment, epoxy touch ups etc. complete as per direction of Engineer-in-Charge.( MS frame to be paid separately in respective item                                                                                                                                                                                         | Sqm   | 4.8 |
| 17 | Painting with synthetic enamel paint of approved brand and manufacture of required colour to give an even shade :Two or more coats on new work of approved brand and manufacture                                                                                                                                                                                                                                                                                                                                                                                                                                                                                                      | Sqm   | 175 |

|    |                                                                                                                                                                                                                                                                                                                                                                                            |      |     |
|----|--------------------------------------------------------------------------------------------------------------------------------------------------------------------------------------------------------------------------------------------------------------------------------------------------------------------------------------------------------------------------------------------|------|-----|
| 18 | Providing and applying white cement based putty of average thickness 1 mm, of approved brand and manufacturer, over the plastered wall surface to prepare the surface even and smooth complete.                                                                                                                                                                                            | Sqm  | 200 |
| 19 | Applying priming coats With water thinnable cement primer on wall surface having VOC content less than 50 grams/litre of approved brand and manufacture, having low VOC (Volatile Organic Compound) content.                                                                                                                                                                               | Sqm  | 200 |
| 20 | Wall painting with premium acrylic emulsion paint of interior grade (Two or more coats) having VOC (Volatile Organic Compound ) content less than 50 grams/ litre of approved brand and manufacture, including applying additional coats wherever required to achieve even shade and colour.                                                                                               | Sqm  | 200 |
| 21 | Providing and fixing ISI marked 35 mm thick flush door shutters conforming to IS: 2202 (Part I) non-decorative type, core of block board construction with frame of 1st class hard wood and well matched commercial 3 ply veneering with vertical grains or cross bands and face veneers on both faces of shutters including ISI marked Stainless Steel butt hinges with necessary screws. | Sqm  | 6   |
| 22 | Extra for providing and fixing flush door with decorative veneering on one side only.                                                                                                                                                                                                                                                                                                      | sqm  | 6   |
| 23 | Extra for providing and fixing lipping with teak wood (2nd class) battens of 25 mm minimum depth on all edges of shutters(overall area of door shutter to be measured)                                                                                                                                                                                                                     | sqm  | 6   |
| 24 | Extra if louvers (not exceeding 0.2 sqm) are provided in flush door shutters (overall area of door shutters to be measured).                                                                                                                                                                                                                                                               | Sqm  | 6   |
| 25 | P & F anodised aluminium handles of size 125 mm ISI marked and of approved make with necessary screws complete.                                                                                                                                                                                                                                                                            | Each | 3   |
| 26 | P & F anodised aluminium tower bolt of size 200*10 mm ISI marked as per IS 1868 and of approved make with nut and screw etc all complete                                                                                                                                                                                                                                                   | Nos  | 3   |
| 27 | Providing and fixing aluminium extruded section body tubular type universal hydraulic door closer (having brand logo with ISI, IS : 3564,embossed on the body, door weight upto 36 kg to 80 kg and door width from 701 mm to 1000 mm), with double speed adjustment with necessary accessories and screws etc. complete.                                                                   | Each | 3   |
| 28 | Providing and fixing aluminium hanging floor door( twin rubber) stopper, ISI marked, anodised (anodic coating not less than grade AC 10 as per IS : 1868) transparent or dyed to required colour and shade, with necessary screws etc. complete                                                                                                                                            | Each | 3   |
| 29 | Providing and fixing 100mm brass locks for aluminium doors including necessary cutting and making good etc. complete                                                                                                                                                                                                                                                                       | Each | 3   |
| 30 | P/F Kiln seasoned and chemically treated hollock wood frame of doors, windows, clerestory windows and other frames ,fixed with rawl plug ,drilling necessary holes for rawl plug and also including priming coat of wooden primer applying putty and 2 or more coats of enamel paint to give even finishing                                                                                | Cum  | 0.2 |
| 31 | Brick work with common burnt clay F.P.S. (non modular) bricks of class designation 7.5 with Cement mortar 1:4 (1 cement : 4 coarse sand) in superstructure above plinth level up to floor V level in all shapes and sizes in.                                                                                                                                                              | Cum  | 2.5 |



|    |                                                                                                                                                                                                                                                                                                                                                                                                                                                                                                                                                                                                                                                                                                                                                                                                                                                                                                                                                                                                                                                                    |      |     |
|----|--------------------------------------------------------------------------------------------------------------------------------------------------------------------------------------------------------------------------------------------------------------------------------------------------------------------------------------------------------------------------------------------------------------------------------------------------------------------------------------------------------------------------------------------------------------------------------------------------------------------------------------------------------------------------------------------------------------------------------------------------------------------------------------------------------------------------------------------------------------------------------------------------------------------------------------------------------------------------------------------------------------------------------------------------------------------|------|-----|
| 32 | Providing and fixing anodised aluminium (anodised transparent or dyed to required shade according to IS:1868,minimum anodic coating of grade AC-15) work For shutters of doors, windows ,acp frame & ventilators including providing and fixing hinges/ pivots and making provision for fixing of fittings wherever required including the cost of EPDM rubber / neoprene gasket required with extruded built up standard tubular sections of approved make conforming to IS: 733 and IS: 1285, fixing with dash fasteners of required dia and size, including necessary filling up the gaps at junctions, i.e. at top, bottom and sides with required EPDM rubber/ neoprene gasket etc. Aluminium sections shall be smooth, rust free, straight, mitred and jointed mechanically wherever required including cleat angle, Aluminium snap beading for glazing / panelling, C.P. brass / stainless steel screws, all complete as per given drawings and the directions of IUAC Engineer (Fittings ,Glazing, panelling and dash fasteners to be paid for separately) | KG   | 30  |
| 33 | Providing and fixing glazing with 5 mm thick glass panes of approved make in aluminium door with EPDM rubber / neoprene gasket etc. Complete as per the given drawings and the directions of engineer-in-charge. (Cost of aluminium snap beading shall be paid in basic item):                                                                                                                                                                                                                                                                                                                                                                                                                                                                                                                                                                                                                                                                                                                                                                                     | sqm  | 4   |
| 34 | Providing and fixing anodised (AC-15) aluminium round shape handle of outer dia 125 mm with SS screws etc. complete as per direction of Engineer                                                                                                                                                                                                                                                                                                                                                                                                                                                                                                                                                                                                                                                                                                                                                                                                                                                                                                                   | each | 4   |
| 35 | Providing and fixing aluminium sliding door bolts 300x16 mm, ISI marked anodised (anodic coating not less than grade AC 10 as per IS : 1868), transparent or dyed to required colour or shade, with nuts and screws etc. complete .                                                                                                                                                                                                                                                                                                                                                                                                                                                                                                                                                                                                                                                                                                                                                                                                                                | each | 2   |
| 36 | Providing and fixing aluminium tower bolts, 300x10 mm ISI marked, anodised (anodic coating not less than grade AC 10 as per IS : 1868 ) transparent or dyed to required colour or shade, with necessary screws etc. complete :                                                                                                                                                                                                                                                                                                                                                                                                                                                                                                                                                                                                                                                                                                                                                                                                                                     | each | 2   |
| 37 | Providing and fixing 25 mm thick Pre-laminated flat pressed three layer particle board or graded wood particle board IS: 12823 marked, exterior grade (Grade I Type II), having one side decorative lamination and other side balancing lamination, including IInd class teak wood lipping of 25 mm wide x12 mm thick with necessary screws and bright finished stainless steel piano hinges, complete for making shutters of cupboards.                                                                                                                                                                                                                                                                                                                                                                                                                                                                                                                                                                                                                           | sqm  | 10  |
| 38 | Providing and fixing teak wood edging /lipping (25 x 5 mm) with 2nd class teak wood on all exposed edges of wooden shutter                                                                                                                                                                                                                                                                                                                                                                                                                                                                                                                                                                                                                                                                                                                                                                                                                                                                                                                                         | rmtr | 15  |
| 39 | P/F Kiln seasoned and chemically treated hollock wood frame on brick work for fixing shutter including making rebate ,fixed with rawl plug ,drilling necessary holes for rawl plug and also including priming coat of wooden primer applying putty and 2 or more coats of enamel paint to give even finishing                                                                                                                                                                                                                                                                                                                                                                                                                                                                                                                                                                                                                                                                                                                                                      | cum  | 0.1 |
| 40 | Providing and fixing Triple strip vertical type magnetic catcher of approved quality in cupboard / ward robe shutters, including fixing with necessary screws etc. complete                                                                                                                                                                                                                                                                                                                                                                                                                                                                                                                                                                                                                                                                                                                                                                                                                                                                                        | Each | 4   |
| 41 | Providing and fixing special quality chromium plated brass cupboard locks (size 65 mm ) with six levers of approved makes quality including necessary screws etc. complete                                                                                                                                                                                                                                                                                                                                                                                                                                                                                                                                                                                                                                                                                                                                                                                                                                                                                         | Each | 2   |
| 42 | Providing and fixing 75 mm chromium plated brass handles with necessary screws etc. complete                                                                                                                                                                                                                                                                                                                                                                                                                                                                                                                                                                                                                                                                                                                                                                                                                                                                                                                                                                       | Each | 4   |

